

st. cloud window

390 Industrial Blvd.
Sauk Rapids, MN 56379
PH: (320) 251-9311
PH: 1-800-383-9311

Window Frame Installation

1. Check Approved Shop Drawing for correct location and label of the window being installed.
2. Measurements of window must be verified for proper fit in rough opening.
3. Examine ALL balances to be secured and aligned correctly in balance carrier. (Fig. A-1)
4. Install shear blocks at sill to Drawing.
5. Using approved shims, insert frame into opening and center frame vertically and horizontally. Fasten frame with installation screws, leaving jambs plumb. Do not tighten screws all the way to allow room for adjustment. (Fig. A-2) Check for square, shim if needed, tighten screws.
6. Critical Quality Inspection
 - ✓ Confirm Frame is plumb and level
 - ✓ Verify squareness of frame
 - ✓ Measure diagonals (A=B) (Fig. A-3)
 - ✓ Check for bowing of frame
 - ✓ Measure distance across jambs (C=D) (Fig. A-5)
 - ✓ Measure distance across head and sill (E=F) (Fig. A-4)

Standard Installation Instructions

5020-01

5000 Hung



FIG A-1

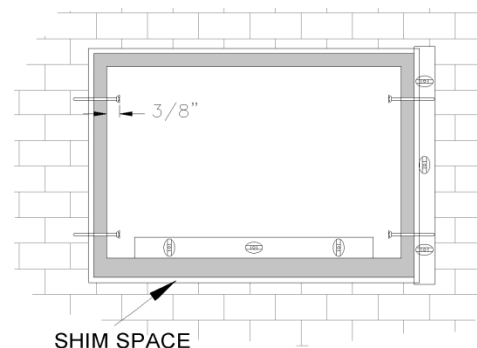
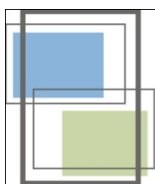

FIG A-2

NOTE: Please inspect window before installing, if any damage has occurred contact **St. Cloud Window**



st. cloud window

390 Industrial Blvd.
Sauk Rapids, MN 56379
PH: (320) 251-9311
PH: 1-800-383-9311

ASTM E 2112-07 5.15.5

Standard Practice for Installation of Exterior Windows, Doors and Skylights

Note: Products shall not be racked more than 1/8 in. (3 mm) out of square for dimensions up to 4 ft (1.3 m) or more than 3/16 in. (1.6 mm) for dimensions greater than 4 ft (1.3 m).

Tolerance (+/-)	in./ft	In. Over 4 ft	In. max	Method of Measure
Squareness Fig. A-3	1/64 in.	1/16 in.	1/16 in.	Steel rule or tape, string line, and level
True/rack Fig. A-3	1/32 in.	1/8 in.	3/16 in.	Two strings across corners
Straightness Fig. A-4 & A-5	1/64 in.	1/16 in.	1/16 in.	Level or plumb line and steel rule or tape
Plumb Fig. A-4	1/32 in.	1/8 in.	1/8 in.	Level or plumb line and steel rule
Level Fig. A-5	1/32 in.	1/8 in.	1/8 in.	Level and steel rule

Standard Installation Instructions

5020-03

5000 Hung

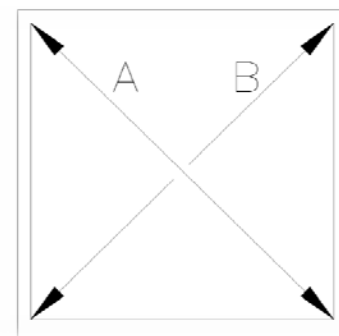

Fig. A-3

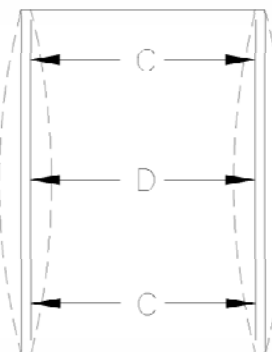

Fig. A-4

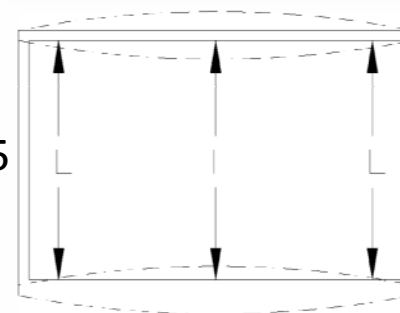
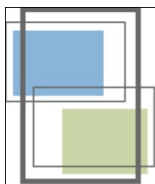

Fig. A-5

NOTE: Please inspect window before installing, if any damage has occurred contact **St. Cloud Window**



st. cloud window

390 Industrial Blvd.
Sauk Rapids, MN 56379
PH: (320) 251-9311
PH: 1-800-383-9311

Standard Installation Instructions
5020-02

5000 Hung

Sash and Screen Installation

1. Check Approved Shop Drawing for correct location and label of sash and screen being installed.
2. Screen is to be installed first. Put screen thru frame, springs on left-hand side and sticker facing you on bottom rail. Insert spring side into frame first and rock into place. (FIG A-6)
3. Double check balances and carriers are secure, if not, with proper tool (Tensioning Tool 16T36), apply quarter turn and pull balance down from bottom pin and lock top pin into Carrier. (FIG A-1)
4. Next install Upper Sash. (FIG A-7) Slide past dust block, insert into frame and rock into place. Center Sash in frame (1/2" engagement) and slide downward to pick up carrier. (FIG A-8) With screw driver lock in clips on carrier to secure sash. (FIG A-9) Fasten Sash Guides on top of each jamb. (FIG A-10)
5. Lastly install Lower Sash. Follow same process as step 4. Fasten Sash Guides. (FIG A-10)
6. Critical Quality Inspection

- ✓ Check screen for proper fit
- ✓ Operate sash for appropriate alignment and movement.
- ✓ Verify balances are working and tension is correct.
- ✓ Ascertain that the sash guides are installed and glide within the frame.

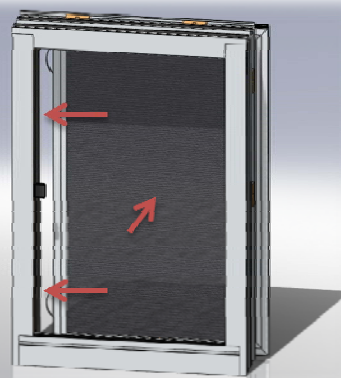

Fig. A-6

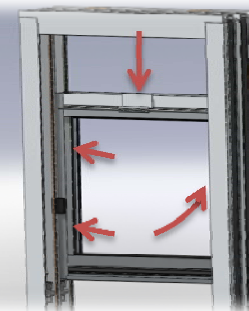

Fig. A-7

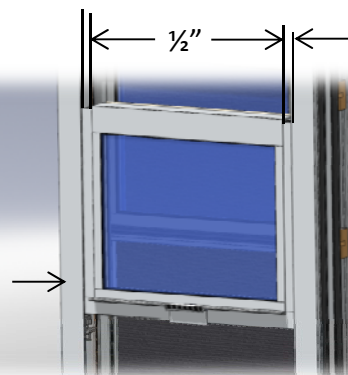

Fig. A-8

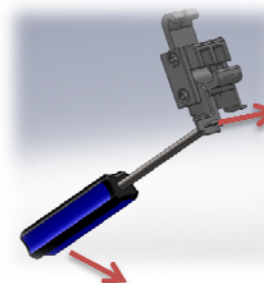

Fig. A-9

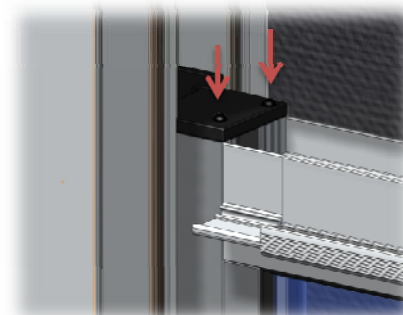

FIG A-10

NOTE: Please inspect window before installing, if any damage has occurred contact **St. Cloud Window**