

Product Selection Guide



st. cloud window

	Frame Depth	Glazing	Thermal U Value	Thermal SHGC	Acoustic STC	Acoustic OTC	Air Infiltration at 6.24 lbf/ft ²	Water Penetration	Structural Load Pressure	Condensation CR	Condensation CRF	Forced Entry Rating	FGIA Rating	Test Size	General Purpose	Acoustic	Historic	Impact	Venetian blinds	Removable Sash	Tilt-Turn	Security ATFP	Secondary/Storm
SCW900Series																							
920 Vertical Sliding	5"-9"	Dual ≤ 0.5"	.31-.34	0.18	39-55+	27-42	.09 cfm/ft ²	9 psf	± 60 psf	38-45		Grade 10	LC-PG60	56" x 91"		●		●	●			●	●
940 Horizontal Sliding	5"-9"	Dual ≤ 0.5"	0.32	0.16	39-55+	27-49	.06 cfm/ft ²	9 psf	± 60 psf	38-46		Grade 10	LC-PG60	71" x 60"		●		●	●			●	●
960 Fixed	5"-9"	0.5 - 1.25"	0.33	0.20	44-55+	35-48	.01 cfm/ft ²	15 psf	± 100 psf	44-48		Grade 10	AW-PG70	60" x 99"		●		●	●			●	●
SCW3000Series																							
3010 Awning	3"4"/5"	1" - 1.5"	.32 - .37	.13-.29	34-41	26-34	.04 cfm/ft ²	15 psf	± 150.3 psf	47-52		Grade 10	AW-PG100	60" x 36"		●		●					
3030 Hopper	3"4"/5"	1" - 1.5"	.32 - .37	.13-.29	33-42	26-35	TBD	15 psf	± 150.3 psf	47-52		Grade 10	AW-PG100	36" x 60"		●		●		●			
3010 Casement	3"4"/5"	1" - 1.5"	.32 - .37	.13-.29	33-42	26-35	.04 cfm/ft ²	15 psf	± 135.0 psf	48-55		Grade 10	AW-PG90	36" x 60"		●		●		●			
3060 Fixed	3"4"/5"	1" - 1.5"	.25 - .31	.16-.36	31-41	24-34	<.01 cfm/ft ²	15 psf	± 150.3 psf	46-51		Grade 10	AW-PG100	60" x 99"		●		●		●			
3060 Fixed Offset	4"/5"	1" - 1.5"	.25 - .31	.16-.36	31-41	24-34	<.01 cfm/ft ²	15 psf	± 150.3 psf	46-51		Grade 10	AW-PG100	60" x 99"		●		●		●			
3000TD Terrace Door	3"	1" - 1.5"	.32-.37	.13-.27	36-45	29-36		15 psf	± 113.0 psf	47-49				48" x 96"		●		●		●			
3060 Fixed Transom	3"	1" - 1.5"	.25 - .31	.16-.36	31-41	24-34	<.01 cfm/ft ²	15 psf	± 150.3 psf	46-51		Grade 10	AW-PG100	60" x 99"		●		●		●			
SCW4000Series																							
Vertical Sliding	4"	1 - 1.25"	.35-.58	.12-.54	28-44	22-37	.019 cfm/ft ²	12.00 psf	105 psf	43-45	60	Grade 10	AW-PG70	60" x 99"		●		●		●			●
Horizontal Sliding	4"	1 - 1.25"	.35-.58	.12-.54	34-44	26-35	.04 cfm/ft ²	10.00 psf	105 psf	42-44	60	Grade 10	AW-PG 50/IP70	99" x 60"		●		●		●			●
Simulated Fixed	4"	1 - 1.25"	.24-.56	.12-.54	32-51	26-42	.01 cfm/ft ²	12.00 psf	105 psf	42-47	65	Grade 10	AW-PG70	60" x 99"		●		●		●			●
SCW4500Series																							
4500 Door	4.5"	1"	.45-.64	.12-.48	29-45	26-37	.06 cfm/ft ²	0 @ 10psf	±90.2 psf	46-47			AW-PG60*	48" x 96"		●		●					
4560 Window	4.5"	1"	.26-.52	.12-.48	34-44	26-34	0 cfm/ft ²	0 @ 20psf	± 150 psf	63-70			AW-PG100	60" x 99"		●		●					
SCW5000Series																							
5020 Vertical Sliding	5"	1 - 1.25"	0.4	0.19	32-37	27-32	.13 cfm/ft ²	15.03 psf	± 135.5 psf	40-41	52-54	Grade 10	AW-PG90	60" x 99"		●		●		●			
5040 Horizontal Sliding	5"	1 - 1.25"	0.4	0.19	32-42	25-35	.102 cfm/ft ²	12.11 psf	± 150.3 psf	42-47	59-64	Grade 10	AW-PG100	99" x 60"		●		●		●			
5060 Fixed	5"	1 - 1.25"	0.4	0.19	40	36	.13 cfm/ft ²	15.03 psf	± 150.3 psf	45-46	59-60	Grade 10	AW-PG100	60" x 99"		●		●		●			
5000SGD Sliding Door	5"	1.125" - 1.5"	.33-.51	.14-.55	34-41	26-33	.175 cfm/ft ²	9.81psf	± 120.0 psf	45-47				122" x 95"		●		●		●			
5060 Fixed Transom	5"	1.125" - 1.5"	0.4	0.19	40	36	.13 cfm/ft ²	15.03 psf	± 150.3 psf	45-46	59-60	Grade 10	AW-PG100	60" x 99"		●		●		●			
SCW9000Series																							
9000-A9 Curtain Wall	9"	1" IG + 0.5"	.21-.55	0.25	54	47	0.01 cfm/ft ²	12.00 psf		40 - 63			AW-PG100	60" x 95.25"		●							

* limited water

SCW 900 Series Windows

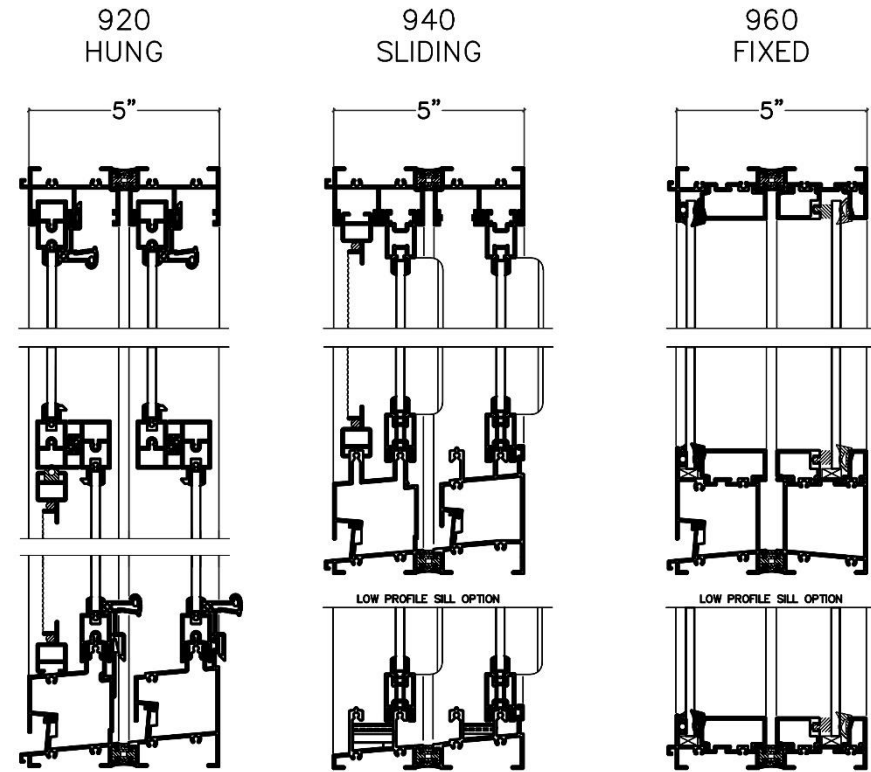

SCW 3000 Series Windows

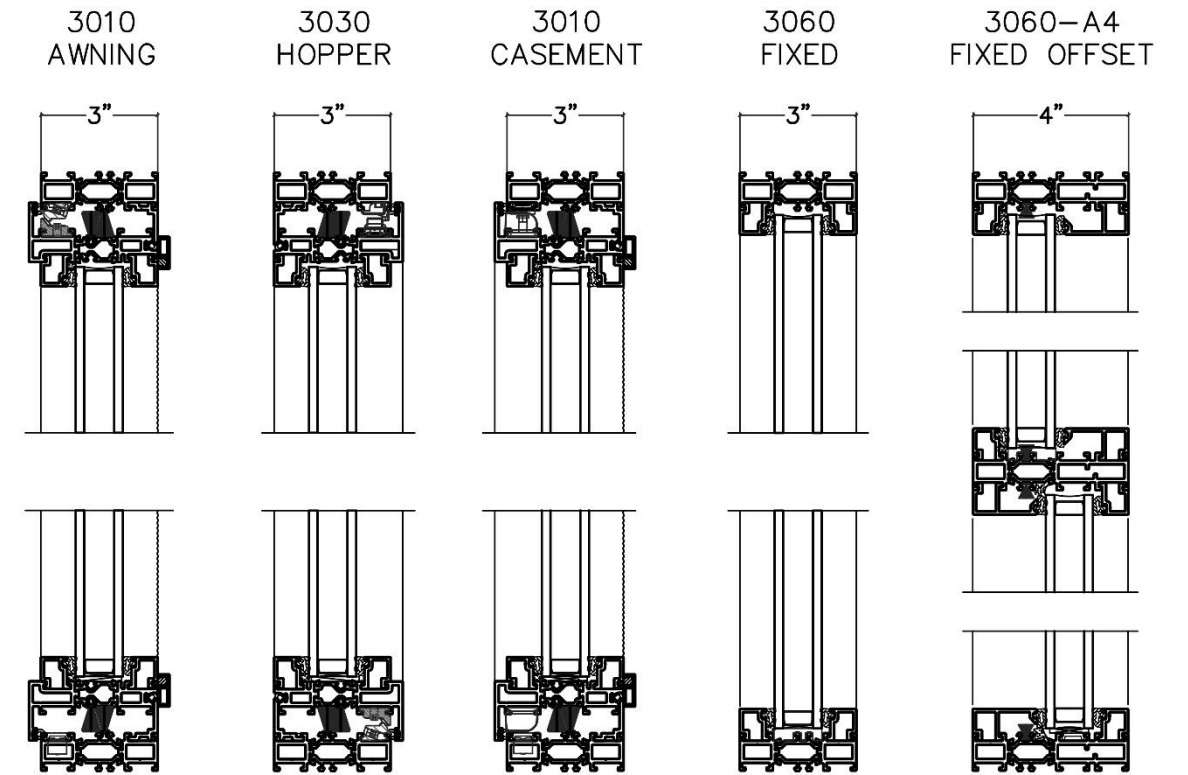

SCW 4000 Series Windows

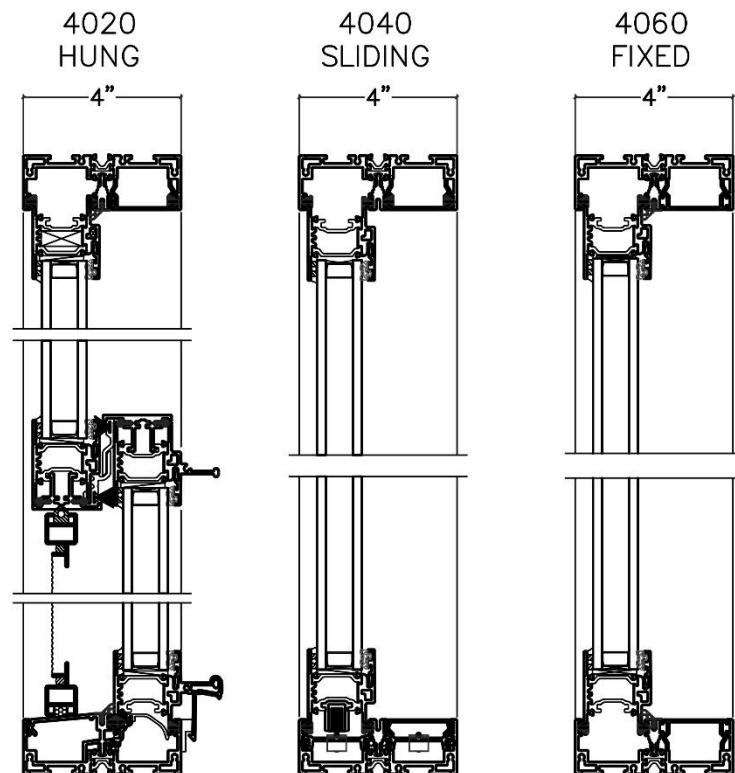

SCW 5000 Series Windows

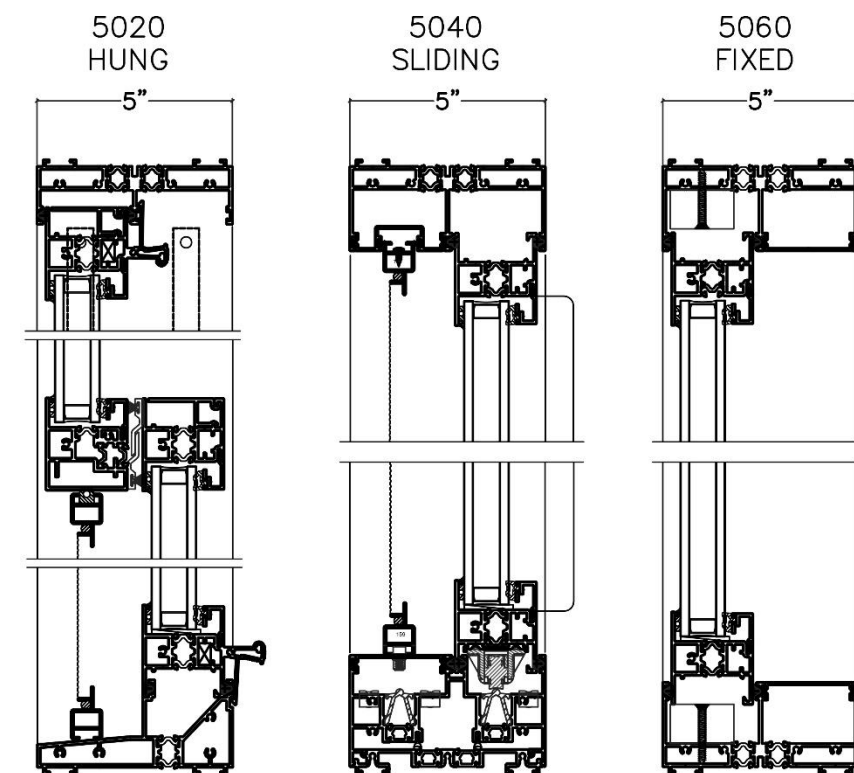

Product Detail Guide

SCW doors

3000
TERRACE

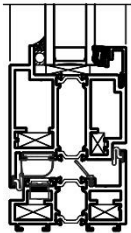
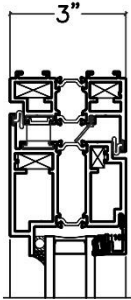

5000
SLIDING

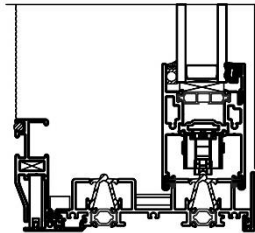
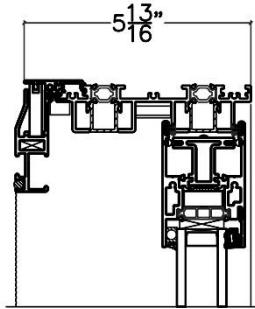

SCW 9000 Curtain Wall

9000
CURTAIN WALL

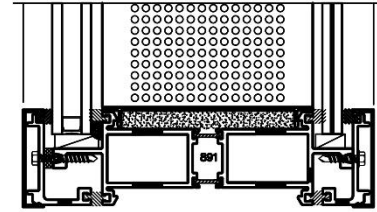
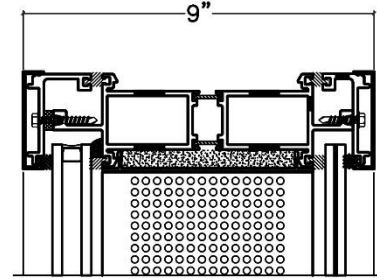

SCW 4500 Storefront & Entrance System

4500
STOREFRONT

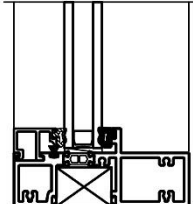
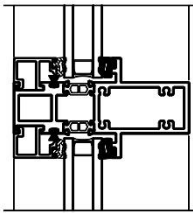
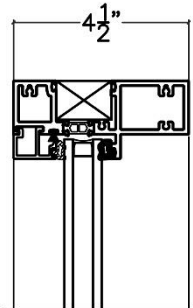

4500
ENTRANCE DOOR

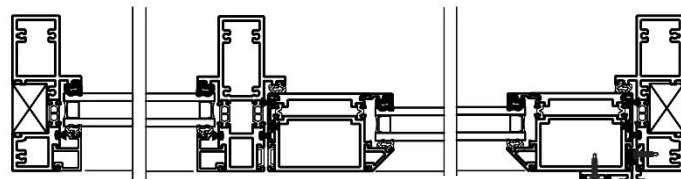
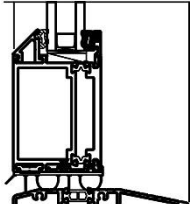
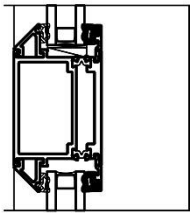
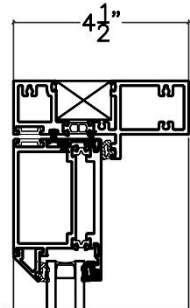

4500 ENTRANCE DOOR



st. cloud window

390 Industrial Blvd, Sauk Rapids, MN 56379
800.393.9311 | www.stcloudwindow.com